

1 BLOW-UP PLAN - LAUNDRY ROOM
SCALE: 1:50 MTS

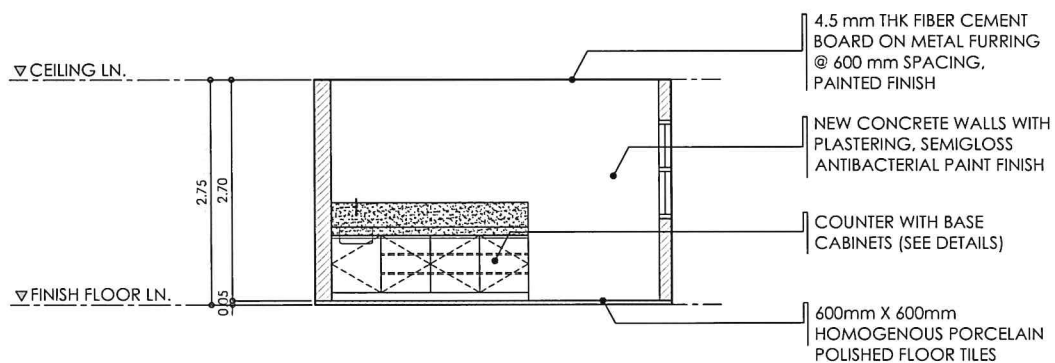

2 ELEVATION "I" - LAUNDRY ROOM
SCALE: 1:50 MTS

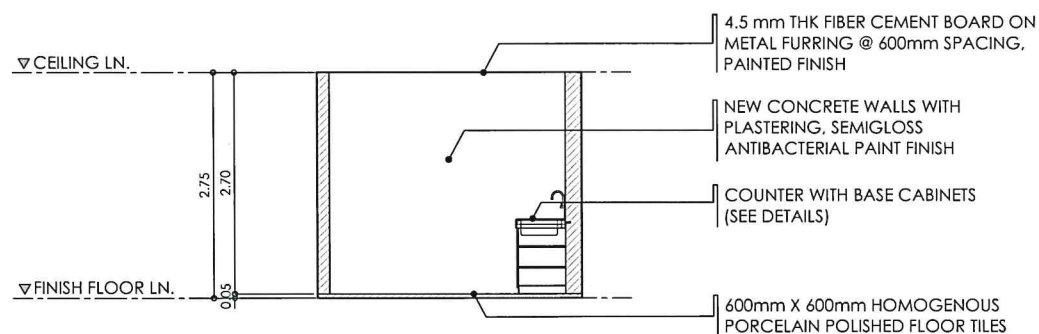

3 ELEVATION "J" - LAUNDRY ROOM
SCALE: 1:50 MTS

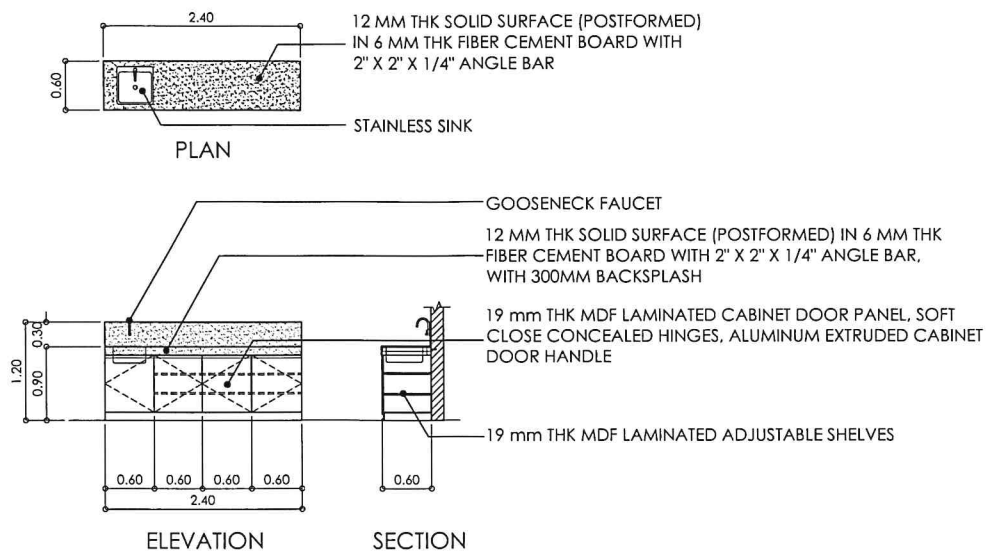

4 COUNTER WITH BASE CABINET DETAIL
SCALE: 1:50 MTS

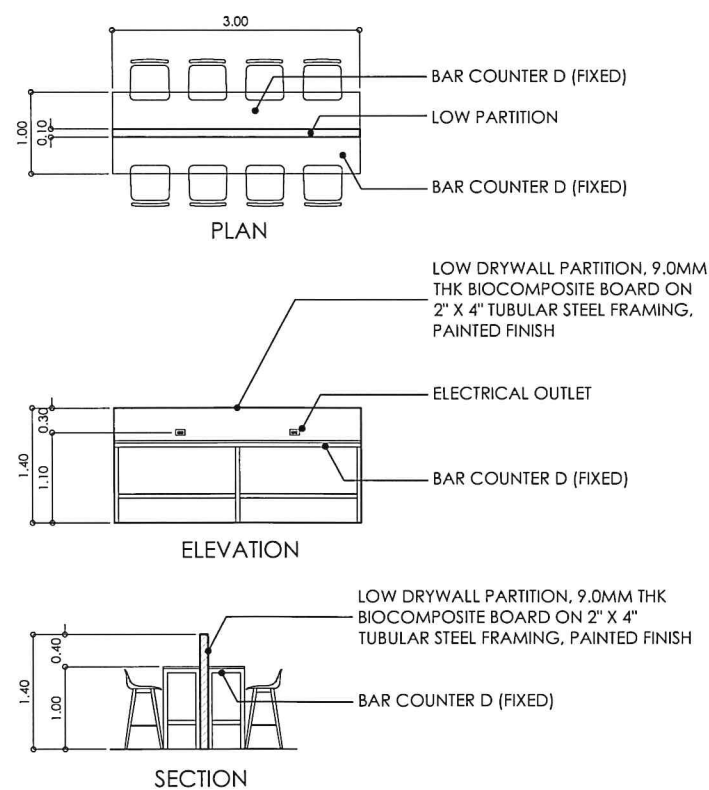

5 LOW PARTITION DETAIL
SCALE: 1:50 MTS

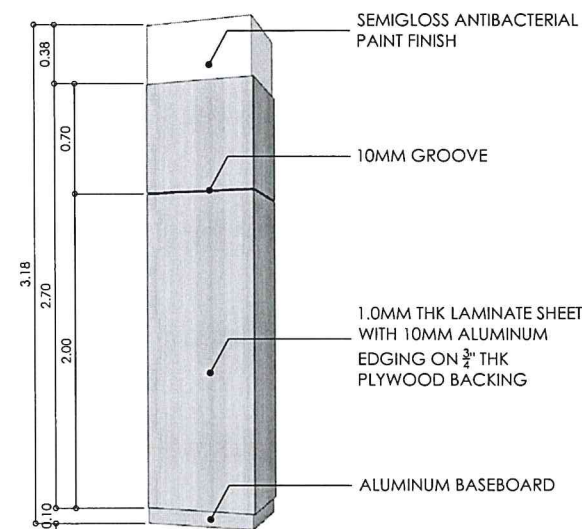

6 TYPICAL DETAIL
COLUMN & CABINET TREATMENT
SCALE: NTS

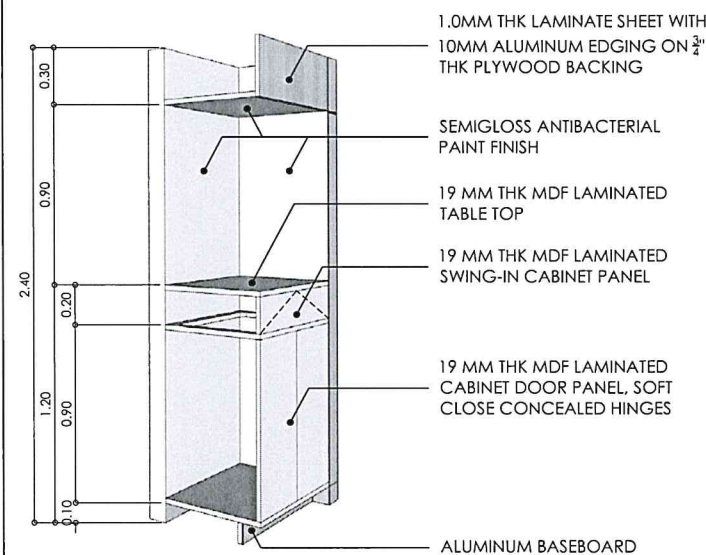

7 TYPICAL DETAIL (TRASHBIN INCLUDED)
TRASH BIN CABINET DETAIL
SCALE: NTS

<p>CAMPUS PLANNING DEVELOPMENT & MAINTENANCE OFFICE U.P. MANILA P. Faura Street, Ermita, Manila Tel. No. 525-2233 Telefax No. 526-8420</p>	<p>ARCHITECT OF RECORD: AR. JOVY D. GALVAN ARCHITECT</p>	<p>ENDORSED BY: AR. ROSALIE G. FLORES-BERNARDO CHIEF, CPDMO</p>	<p>PROJECT TITLE: PROPOSED INTERIOR FIT-OUT OF GROUND FLOOR, UP MANILA STUDENT DORMITORY UNIVERSITY OF THE PHILIPPINES MANILA</p>	<p>RECOMMENDING APPROVAL: MICHAEL L. TEE, MD, MHPED, MBA VICE CHANCELLOR FOR PLANNING & DEVELOPMENT ARLENE A. SAMANIEGO, MD. VICE CHANCELLOR FOR ADMINISTRATION</p>	<p>APPROVED: CARMENCITA D. PADILLA, MD, MAHPS CHANCELLOR</p>	<p>SHEET CONTENT: ARCHITECTURAL DETAILS</p>	<p>SHEET NO.: A-9 9 OF 12</p>
---	---	--	--	---	---	--	--

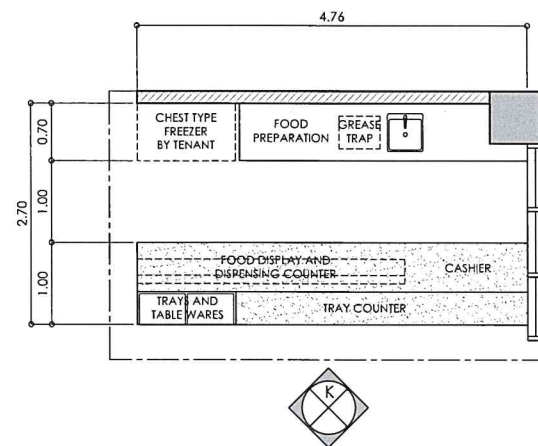

1 BLOW-UP PLAN - FOOD SERVICE AREA
A-10 SCALE: 1:50 MTS

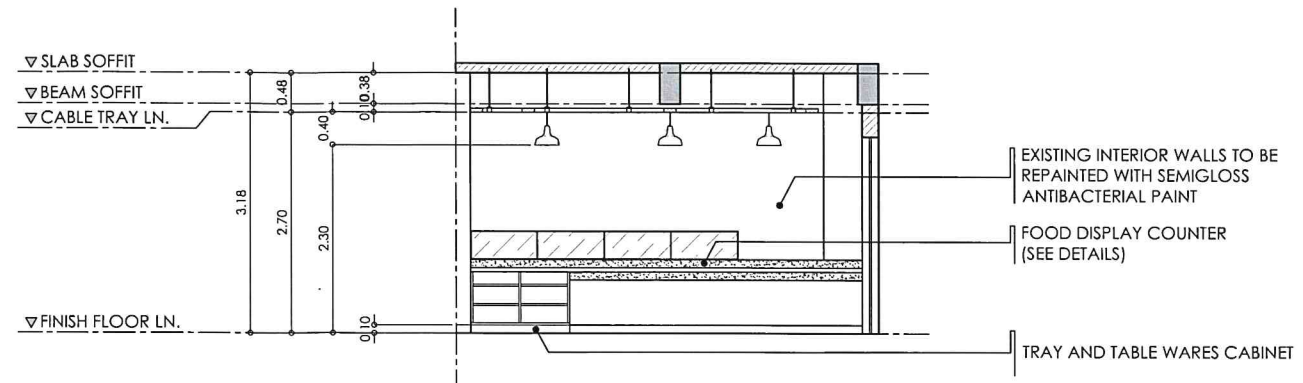

2 ELEVATION "K" - FOOD SERVICE AREA
A-10 SCALE: 1:50 MTS

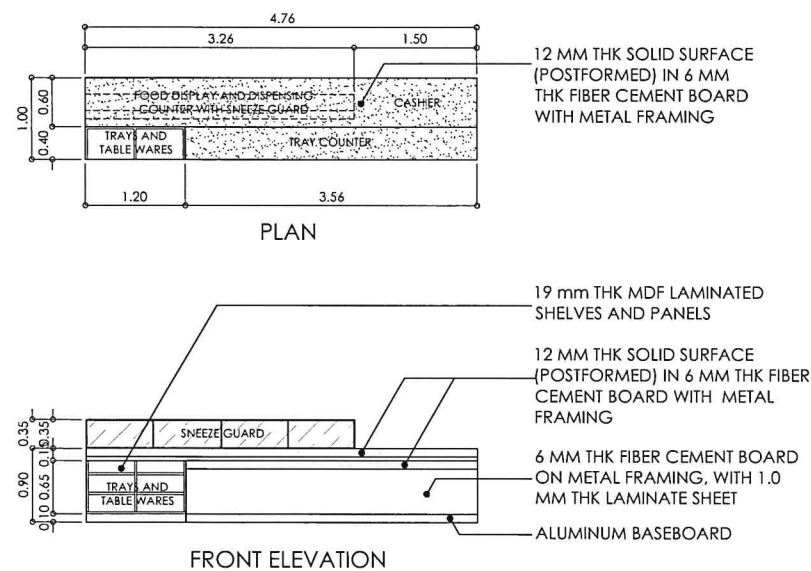

3 FOOD DISPENSING COUNTER DETAIL
A-10 SCALE: 1:50 MTS

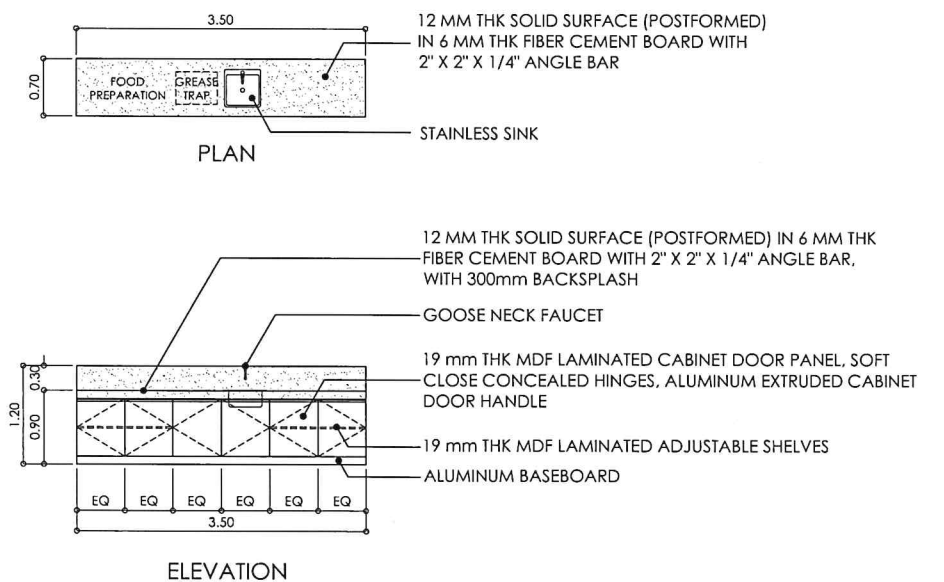
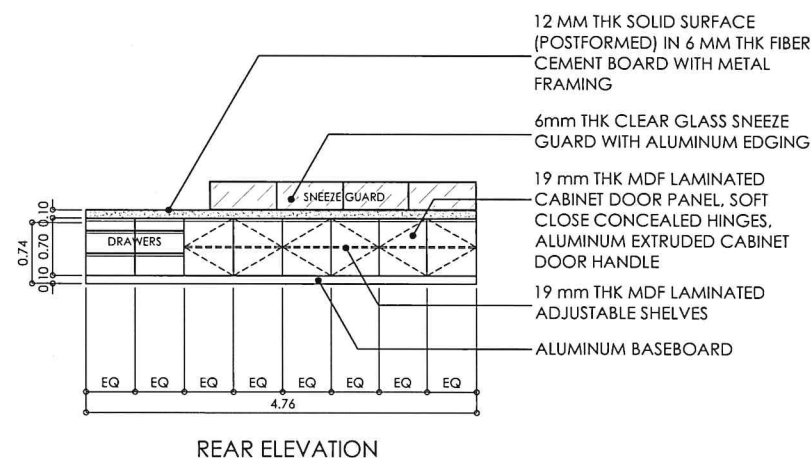

4 FOOD PREPARATION COUNTER DETAIL
A-10 SCALE: 1:50 MTS

<p>CAMPUS PLANNING DEVELOPMENT & MAINTENANCE OFFICE UP MANILA P. Faure Street, Ermita, Manila Tel. No. 525-2233 Telefax No. 525-8420</p> <p>RA 8268 : THIS DRAWING AS AN INSTRUMENT OF SERVICE IS THE PROPERTY OF CPDMO UP MANILA AND SUCH MUST NOT BE REPRODUCED OR COPIED IN OR IN WHOLE WITHOUT PERMISSION.</p>	<p>ARCHITECT OF RECORD: AR. JOYD GALVAN ARCHITECT</p> <p>PRC NO. 0042324 PTR NO. MUA 9191906 TIN NO. 338-867-804 ISSUED ON JAN. 27, 2020 IAPOA 39049-238422-091918 ISSUED AT MANILA</p>	<p>ENDORSED BY: AR. ROSALIE G. FLORES-BERNARDO CHIEF, CPDMO</p>	<p>PROJECT TITLE: PROPOSED INTERIOR FIT-OUT OF GROUND FLOOR, UP MANILA STUDENT DORMITORY UNIVERSITY OF THE PHILIPPINES MANILA</p>	<p>RECOMMENDING APPROVAL: MICHAEL L. TEE, MD, MHPED, MBA VICE CHANCELLOR FOR PLANNING & DEVELOPMENT</p> <p>ARLENE A. SAMANIEGO, MD VICE CHANCELLOR FOR ADMINISTRATION</p>	<p>APPROVED: CARMENCITA D. PADILLA, MD, MAHPS CHANCELLOR</p>	<p>SHEET CONTENT: ARCHITECTURAL DETAILS</p>	<p>SHEET NO.: A-10 10 OF 12</p>
---	--	--	--	---	---	--	--