

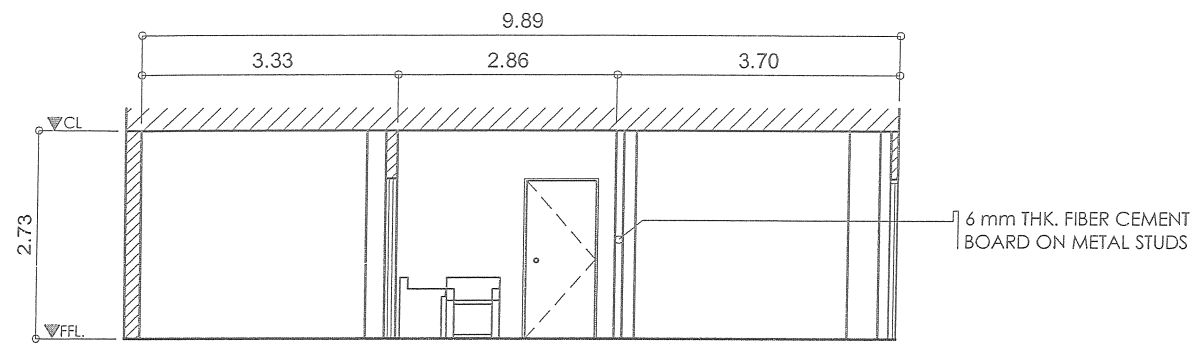

1
SECTION THRU A
SCALE 1:100 MTS

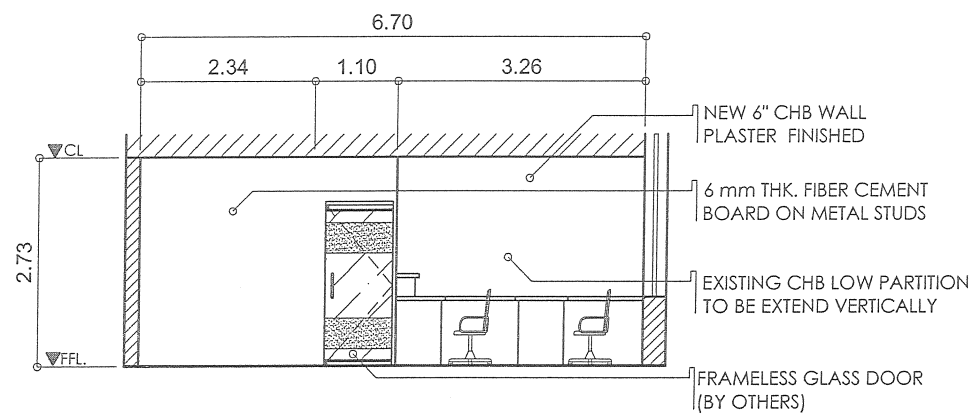

2
SECTION THRU A
SCALE 1:100 MTS



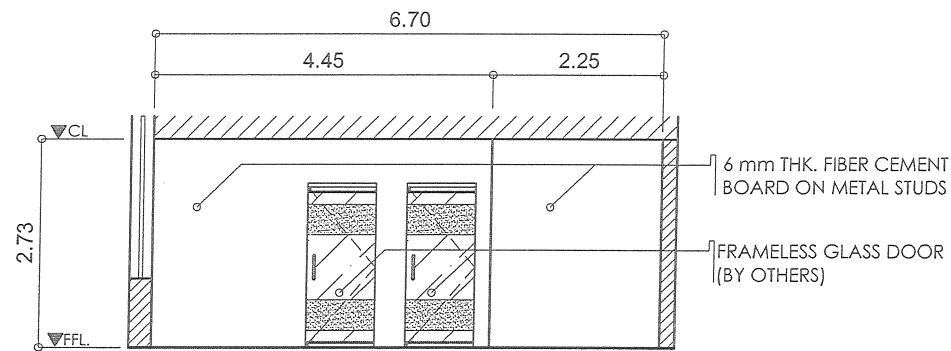

3
SECTION THRU B
SCALE 1:100 MTS

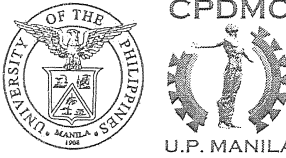

4
SECTION THRU B
SCALE 1:100 MTS

 <p>CPDMO CAMPUS PLANNING DEVELOPMENT & MAINTENANCE OFFICE P. Faura Street, Ermita, Manila Tel. No. 525-2233 Telefax No. 526-8420 U.P. MANILA</p>	<p>CERTIFIED CORRECT:</p> <p>ARCH. ALLEN R. BUENAVENTURA, MCM CHIEF, CPDMO</p>	<p>PROJECT TITLE:</p> <p>PROPOSED RENOVATION OF FACULTY ROOM (PHASE 1) GROUND FLOOR, DEPARTMENT OF EPIDEMIOLOGY, PAZ MENDOZA BUILDING COLLEGE OF MEDICINE UNIVERSITY OF THE PHILIPPINES - MANILA</p>	<p>RECOMMENDING APPROVAL:</p> <p><i>Marissa M. Alejandria</i> MARISSA M. ALEJANDRIA, M.D. CHAIRMAN</p> <p><i>Agnes D. Mejia</i> AGNES D. MEJIA, M.D. DEAN, COLLEGE OF MEDICINE</p>	<p>APPROVED:</p> <p><i>Jose Florencio F. Lapeña Jr.</i> JOSE FLORENCIO F. LAPEÑA JR., MD VICE-CHANCELLOR FOR ADMINISTRATION</p> <p><i>Charlotte M. Chiong</i> CHARLOTTE M. CHIONG, M.B., PH.D. VICE-CHANCELLOR FOR PLANNING & DEVELOPMENT</p> <p>16 APR 2014</p>	<p>SHEET CONTENT:</p> <p>SECTION THRU A SECTION THRU B</p>	<p>DATE ISSUED:</p> <p>DATE REVISED:</p> <p>REVISION NO.:</p> <p>REF. NO.:</p> <p>WD094NP03052014</p> <p>RUP2013RHCCHC.MARPERMANO CADD FILE: LOG11PHASE1110141.PLA/PLW/ EPIDEMIOLOGY/PHASE11.DWG/1</p>	<p>SHEET NO.:</p> <p>A-4</p> <p>4 OF 12</p>
	<p>PREPARED BY:</p> <p><i>Bonifacio J. Romasanta</i> BONIFACIO J. ROMASANTA DRAFTSMAN</p> <p><i>Arch. Leonard P. Cordero</i> ARCH. LEONARD P. CORDERO ADMINISTRATIVE OFFICER V</p> <p>CADD BY: JOVENCIO M. SUASE JR.</p>	<p>RA 9266 : THIS DRAWING AS AN INSTRUMENT OF SERVICE IS THE PROPERTY OF CPDMO UP MANILA AND SUCH MUST NOT BE REPRODUCED OR COPIED IN OR IN WHOLE WITHOUT PERMISSION.</p>					





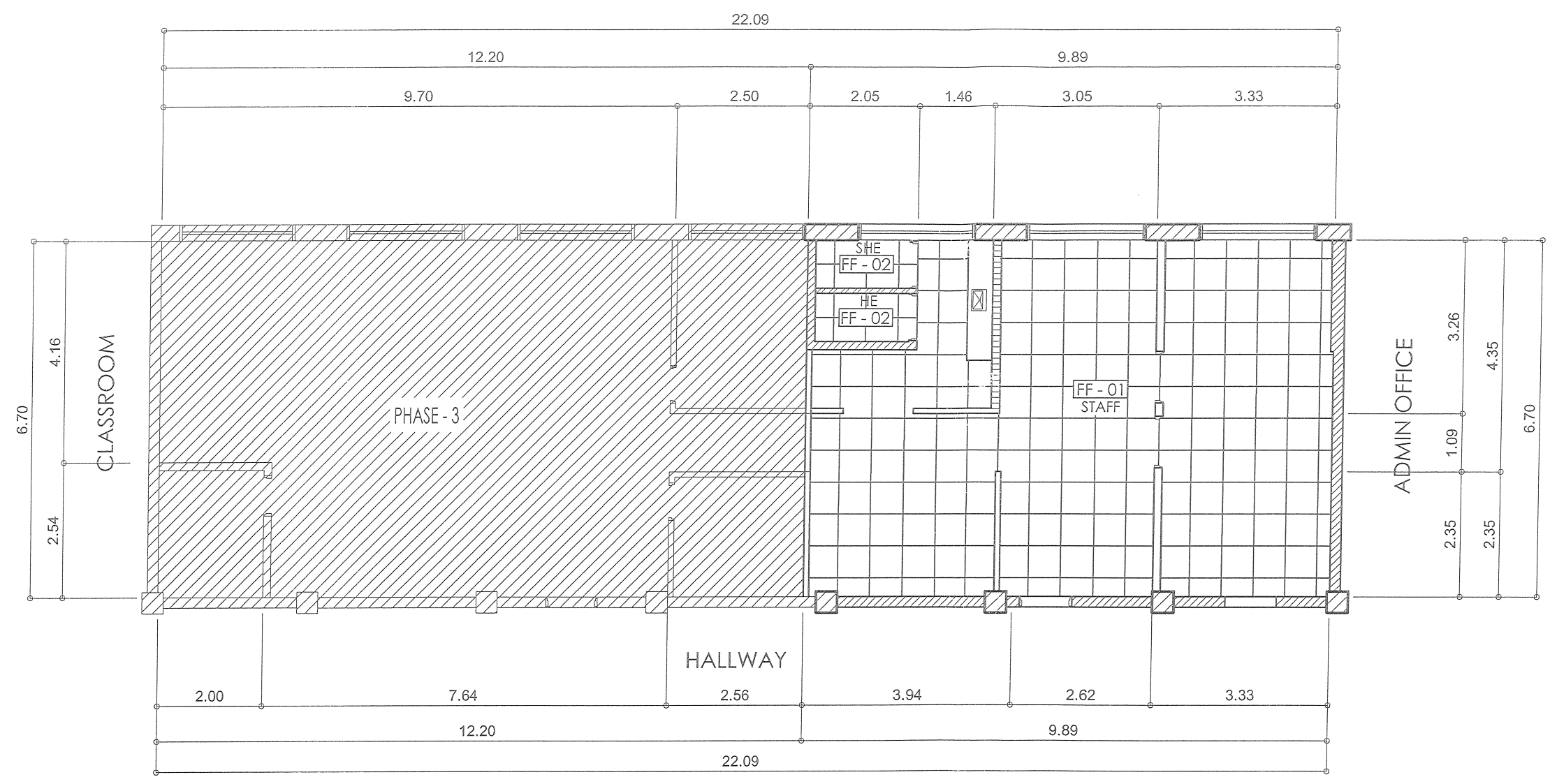

LEGEND	CODE	SPECIFICATIONS
	FF-01	600mm X 600mm NORTHPOLE WHITE SUPERWAX, PORCELAIN TILES
	FF-02	600mm X 600mm MARKET BEIGE MATTE, PORCELAIN TILES
	PHASE 3	NOT INCLUDED

GENERAL NOTES:

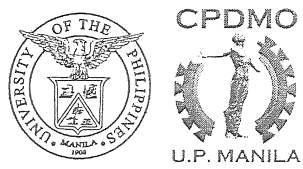
- SETTING OUT FOR THE INSTALLATION SHOULD BE AT THE CENTER OF THE MAIN ENTRANCE OPENING.
- THE LAYOUT/PATTERN REFER TO FLOOR FINISHES LAYOUT.
- FOR FLOOR TERMINATION AND JUNCTION OF FLOOR FINISHES REFER TO DETAILS AS SHOWN.
- CONTRACTOR TO ENSURE PROPER LEVELING OF FLOOR SUBSTRATE PRIOR TO INSTALLATION OF FLOOR FINISHES.
- CONTRACTOR TO ENSURE PROPER INSTALLATION, TERMINATION AND JUNCTION OF FINISHES TO EXISTING WALL AND FLOORS AS PER BUILDING PROPERTY STANDARDS.

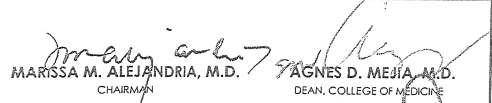
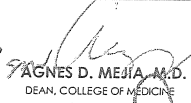

1
A-5 FLOOR FINISH PLAN
SCALE 1:100 MTS

 CAMPUS PLANNING & MAINTENANCE OFFICE P. Faura Street, Ermita, Manila Tel. No. 525-2233 Telefax No. 526-8420 U.P. MANILA	CERTIFIED CORRECT:  ARCH. ALLEN R. BUENAVENTURA, MCM CHIEF, CPDMO	PROJECT TITLE: PROPOSED RENOVATION OF FACULTY ROOM (PHASE 1) GROUND FLOOR, DEPARTMENT OF EPIDEMIOLOGY, PAZ MENDOZA BUILDING COLLEGE OF MEDICINE UNIVERSITY OF THE PHILIPPINES - MANILA	RECOMMENDING APPROVAL:  MARISSA M. ALEJANDRIA, M.D. CHAIRMAN  AGNES D. MEJIA, M.D. DEAN, COLLEGE OF MEDICINE	APPROVED:  JOSE FLORENCIO F. LAPEÑA JR., MD VICE CHANCELLOR FOR ADMINISTRATION	SHEET CONTENT: FLOOR FINISH PLAN	DATE ISSUED: DATE REVISED: REVISION NO.: REF. NO.: WDO94NPG03052014 CADD FILE: RUP20130814CIVILMIPROD40 LOGS\PHASE 1\PHASE 1\PLANS\EPIDEMIOLOGY\PHASE 1\00014	SHEET NO.: A-5 5 OF 12
	PREPARED BY:  BON JUAN J. ROMASANTA DRAFTSMAN  ARCH. LEONARD P. CORDERO ADMINISTRATIVE OFFICER V	CADD BY: JOVENCIO M. SUASE JR.					

RA 9266 : THIS DRAWING AS AN INSTRUMENT OF SERVICE IS THE PROPERTY OF CPDMO UP MANILA AND SUCH MUST NOT BE REPRODUCED OR COPIED IN OR IN WHOLE WITHOUT PERMISSION.

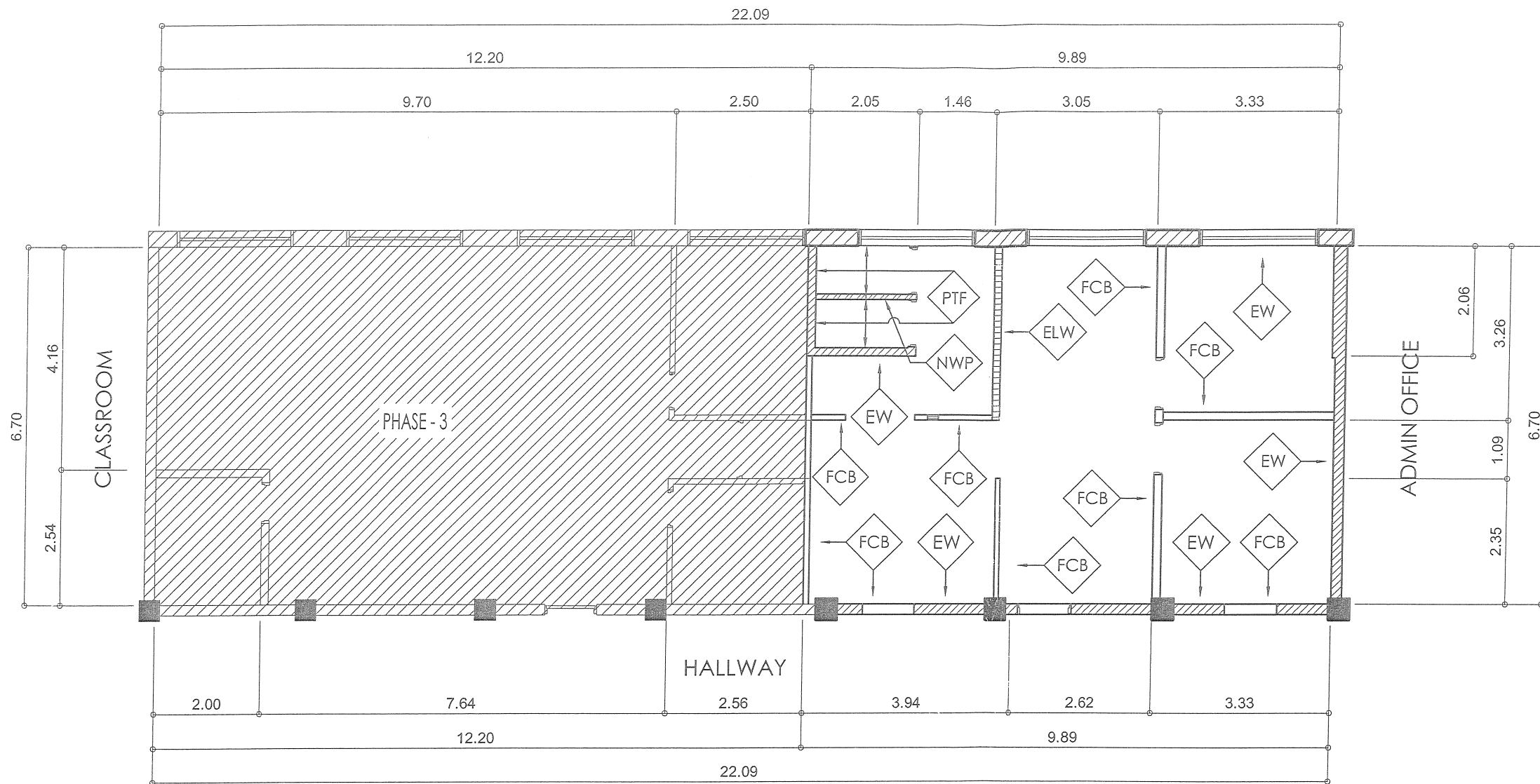

LEGEND	SPECIFICATIONS
	EXISTING CHB WALL TO BE RETAINED. REPAIRING AND REPAINTING WORKS PROVIDE BY OTHERS.
	EXISTING CHB LOW PARTITION TO BE RETAINED/REPAIRED/REPAINTED & TO BE EXTEND W/ 6" CHB, PLASTER FINISHED
	6 mm THK. FIBER CEMENT BOARD ON METAL STUDS
	NEW 6" THK. CHB WALL PARTITION PLASTER FINISHED
	CHB WALL PARTITION IN 1.20 M. HEIGHT 600 mm x 600 mm PORCELAIN TILE FINISHED
	NOT INCLUDED - PHASE 3

GENERAL NOTES:

1. CONTRACTORS SHALL PROVIDE COLOR SWATCHES BEFORE/ PRIOR IMPLEMENTATION.
2. ALL PAINTING WORKS PROVIDE BY OTHERS.
3. CONTRACTORS SHOULD ASSURE ALL WALL BE PROPERTY PREPARED PRIOR.

1 WALL FINISH PLAN
A-6 SCALE 1:100 MTS

<p>CAMPUS PLANNING & MAINTENANCE OFFICE P. Faura Street, Ermita, Manila Tel. No. 525-2233 Telefax No. 526-8420</p>	<p>CERTIFIED CORRECT:</p> <p>ARCH. ALLEN R. BUENAVENTURA, MCM CHIEF, CPDMO</p>	<p>PROJECT TITLE:</p> <p>PROPOSED RENOVATION OF FACULTY ROOM (PHASE 1) GROUND FLOOR, DEPARTMENT OF EPIDEMIOLOGY, PAZ MENDOZA BUILDING COLLEGE OF MEDICINE UNIVERSITY OF THE PHILIPPINES - MANILA</p>	<p>RECOMMENDING APPROVAL:</p> <p><i>Marissa M. Alejandria</i> MARISSA M. ALEJANDRIA, M.D. CHAIRMAN</p> <p><i>Agnes D. Mejia</i> AGNES D. MEJIA, M.D. DEAN, COLLEGE OF MEDICINE</p>	<p>APPROVED:</p> <p><i>Jose Florencio F. Lapeña Jr.</i> JOSE FLORENCIO F. LAPEÑA JR., MD VICE CHANCELLOR FOR ADMINISTRATION</p> <p>16 APR 2014</p>	<p>SHEET CONTENT:</p> <p>WALL FINISH PLAN</p>	<p>DATE ISSUED:</p> <p>DATE REVISED:</p> <p>REVISION NO.:</p> <p>REF. NO.:</p> <p>WD094NPG03052014</p> <p>CADD FILE: I:\UP2013\ENH\CHM\RD\640\LOG\T\PHASE1\WALLFINISH\WALLFINISH103B14</p>	<p>SHEET NO.:</p> <p>A-6</p> <p>6 OF 12</p>
	<p>PREPARED BY:</p> <p><i>Bon Asahan P. Romasanta</i> BON ASAHAN P. ROMASANTA DRAFTSMAN</p> <p><i>Arch. Leonard P. Cordero</i> ARCH. LEONARD P. CORDERO ADMINISTRATIVE OFFICER V</p>	<p>CADD BY: JOVENCIO M. SUASE JR.</p>	<p>RA 9268 : THIS DRAWING AS AN INSTRUMENT OF SERVICE IS THE PROPERTY OF CPDMO U.P. MANILA AND SUCH MUST NOT BE REPRODUCED OR COPIED IN OR IN WHOLE WITHOUT PERMISSION.</p>				